



GRAND DESIGN  
COMPASS® APP  
POWERED BY LCI ONECONTROL®

OWNER'S MANUAL

L I P P E R T  
C O M P O N E N T S®

Post May 31, 2020

# TABLE OF CONTENTS

Introduction .....	2
Safety .....	2
Preparation .....	3
Operation .....	7
HOME Screen .....	7
DEVICES Screen .....	9
SETTINGS Screen .....	11
Troubleshooting .....	11

## Introduction

The Grand Design Compass® Application is based on LCI OneControl® application architecture, which provides system controls and monitoring software for the recreational vehicle. The system can include slide-outs, leveling system, awnings and lighting.

For information on the assembly or individual components of this product, please visit:

<https://support.lci1.com/electronics-support-onecontrol-wireless-formerly-myrvreg>.

**NOTE:** Images used in this document are for reference only when assembling, installing and/or operating this product. Actual appearance of provided and/or purchased parts and assemblies may differ.

**NOTE:** As of document release, the current version of the Grand Design Compass App was version 3.5.1.

## Safety

Read and understand all instructions before installing or operating this product. Adhere to all safety labels.

This manual provides general instructions. Many variables can change the circumstances of the instructions, i.e., the degree of difficulty, operation and ability of the individual performing the instructions. This manual cannot begin to plot out instructions for every possibility, but provides the general instructions, as necessary, for effectively interfacing with the device, product or system. Failure to correctly follow the provided instructions may result in death, serious personal injury, severe product and/or property damage, including voiding of the LCI limited warranty.

### **WARNING**

**The "WARNING" symbol above is a sign that a procedure has a safety risk involved and may cause death or serious personal injury if not performed safely and within the parameters set forth in this manual.**

### **WARNING**

**Failure to follow instructions provided in this manual may result in death, serious personal injury and/or severe product and property damage, including voiding of the component warranty.**

## ⚠ CAUTION

The “CAUTION” symbol above is a sign that a safety risk is involved and may cause personal injury and/or product or property damage if not safely adhered to and within the parameters set forth in this manual.

## ⚠ CAUTION

Moving parts can pinch, crush or cut. Keep clear and use caution.

## Preparation

**NOTE:** Setting up the Grand Design Compass App requires both wifi and Bluetooth to be turned on and the user must be within 25 feet of the trailer. The minimum requirements for a smart phone are IOS 11.0 or newer or Android 5.0 with Bluetooth.

1. Download the free Grand Design Compass App onto a smart phone by searching for Grand Design Compass on the App Store or Google Play (Fig. 1) and press Install (Fig. 2) to launch the app (Fig. 3).

Fig. 1

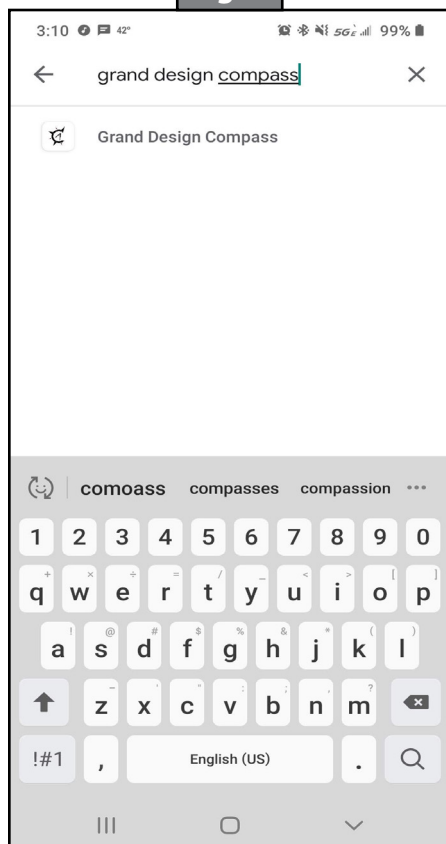

Fig. 2

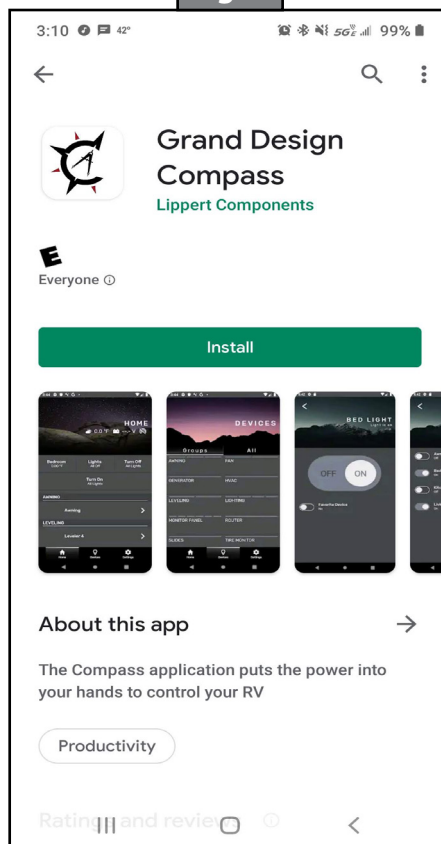
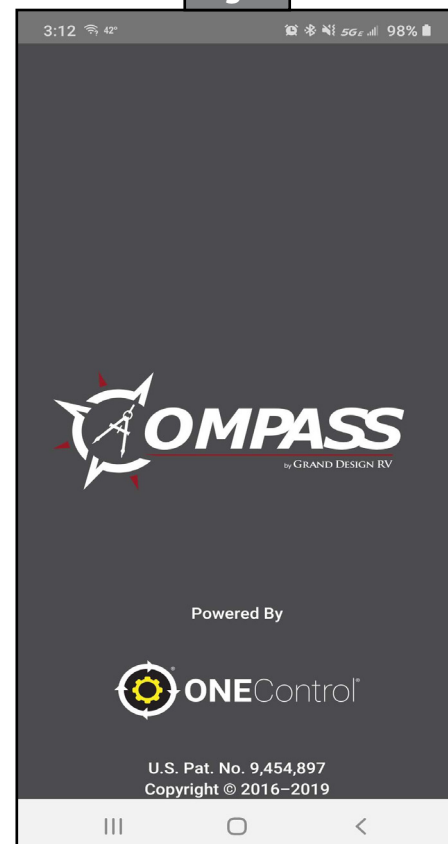

Fig. 3



App Store® is a trademark of Apple Inc. Android™ and Google Play™ are trademarks of Google LLC.

2. Read and agree to the End User License Agreement (Fig. 4).
3. Press Login (Fig. 5A) to log in to the account. Enter account email and password (Fig. 6).
  - A. If you do not have an account, scroll down on the screen (Fig. 6) to the Create Account option (not shown). Enter the required information, including first and last name, email, address, password, phone number and VIN (Fig. 7). The password must be at least eight characters and contain a number and a special character.
4. Compass requires location permissions to find and connect to available networks (Figs. 8, 9 and 10).

**Fig. 4**

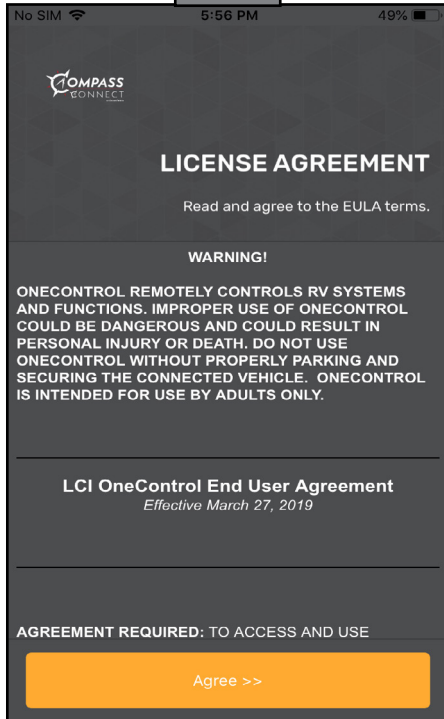

**Fig. 5**

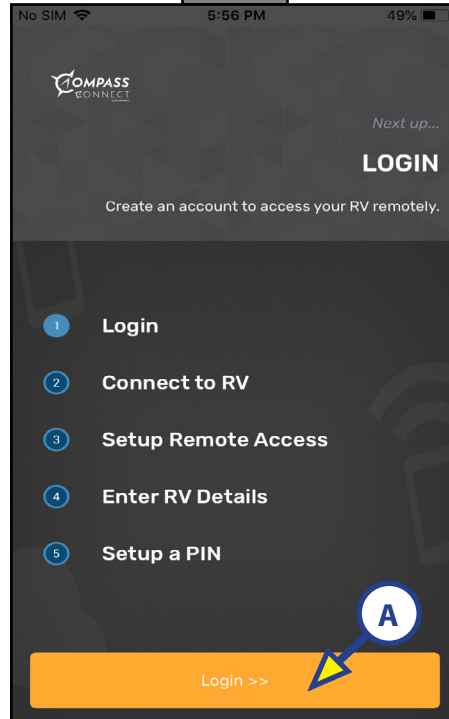

**Fig. 6**

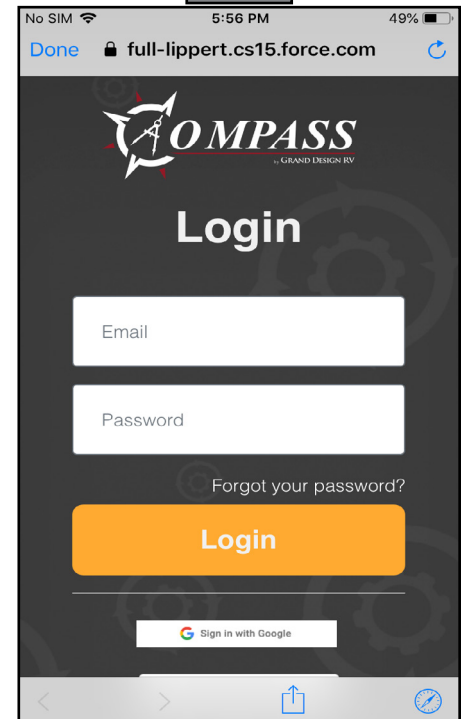

**Fig. 7**

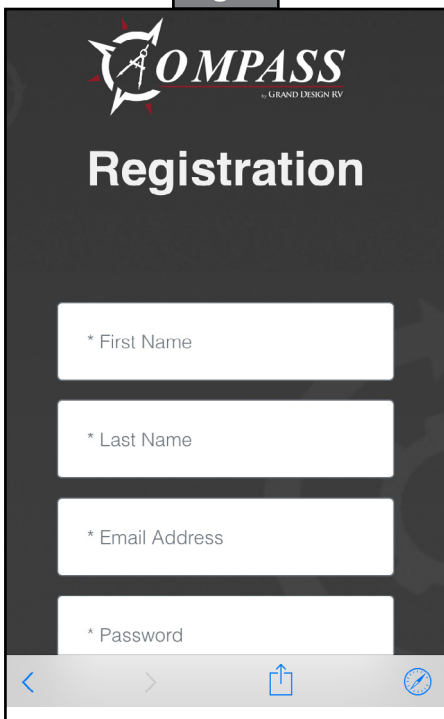

**Fig. 8**

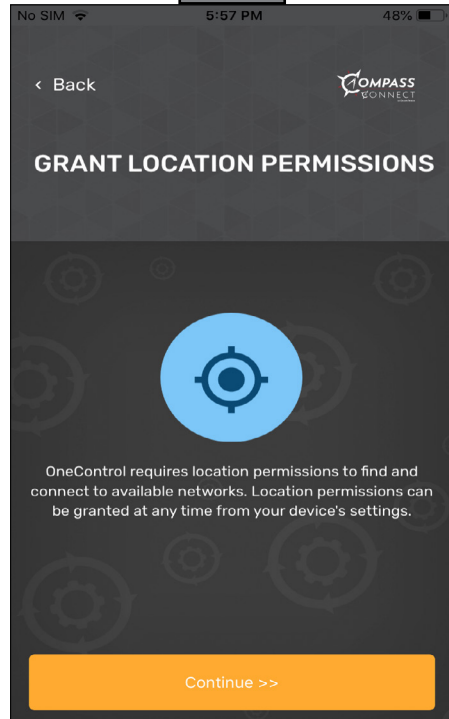

**Fig. 9**

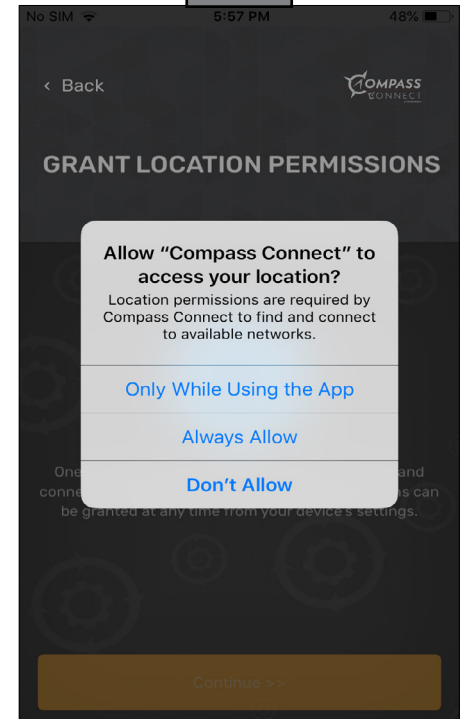

5. Scan the label's QR code with the phone's camera (Figs. 11 and 12).

**NOTE:** A secondary label that can be scanned is usually placed on or near the monitor panel.

**NOTE:** Optionally, press Connect Manually (Fig. 11A) to select an RV gateway from a list. The ID and password are contained on a sticker attached to the gateway in the unit.

6. Press Connect (Fig. 13A) and join the wifi network (Fig. 14A).

7. If setup is successful, the screen will note RV Connected Successfully (Fig. 15.)

Fig. 10

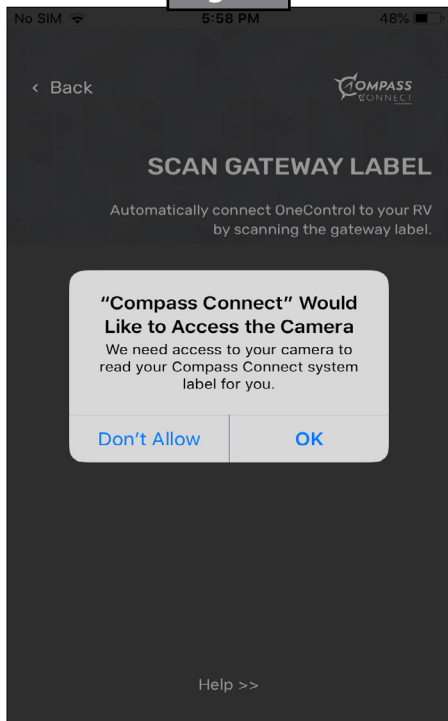

Fig. 11

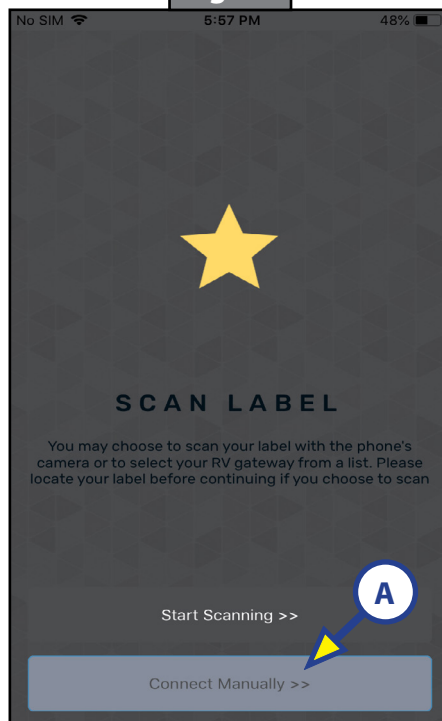

Fig. 12



Fig. 13

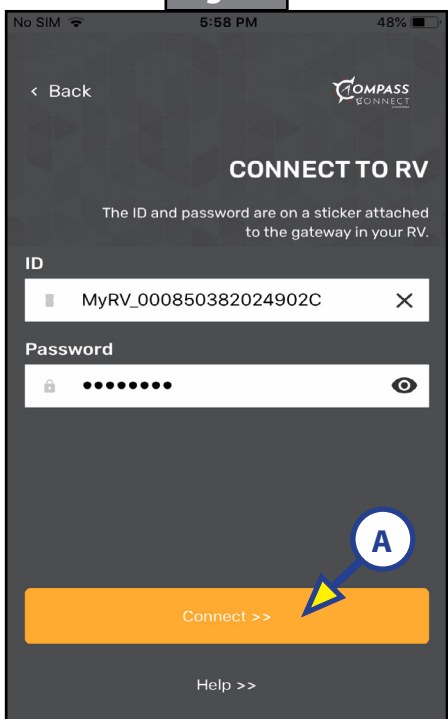

Fig. 14

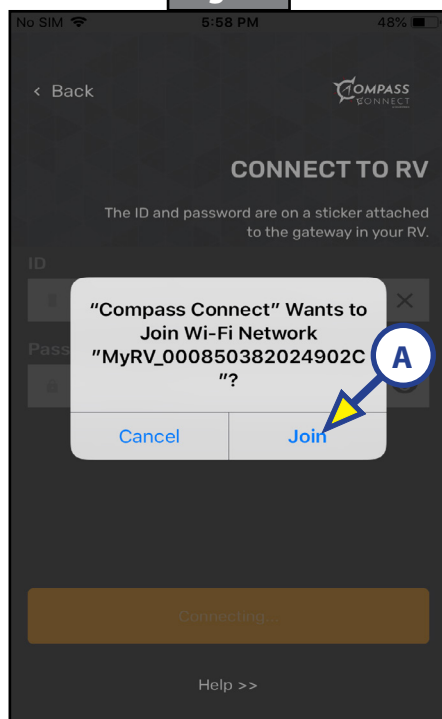
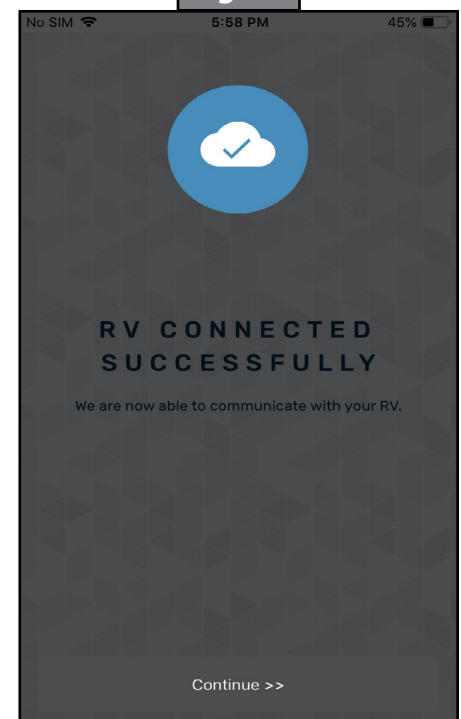

Fig. 15



8. To finish setup, enter details about the RV (Fig. 16), including year (Fig. 17), model (Fig. 18) and floor plan (Fig. 19).
9. Confirm RV details (Fig. 20).

Fig. 16

No SIM 5:58 PM 43%

COMPASS CONNECT

Next up...

### ENTER RV DETAILS

To finish setup we need to collect some information about your primary vehicle.

- ✓ Login
- ✓ Connect to RV
- ✗ Setup Remote Access  
Feature not supported on RV
- 4 Enter RV Details
- 5 Setup a PIN

Let's Go! >>

Fig. 17

No SIM 5:59 PM 41%

< Back COMPASS CONNECT

### SELECT YEAR

Scroll to select the year your RV was made.

- ☐ 2020
- ☐ 2019
- ☒ 2018
- ☐ 2017
- ☐ 2016

Continue >>

Fig. 18

No SIM 5:59 PM 40%

< Back COMPASS CONNECT

### SELECT MODEL

Scroll to select the model of your RV.

- ☐ Reflection
- ☐ Reflection 150
- ☒ Imagine
- ☐ Imagine XLS
- ☐ Solitude

Continue >>

Fig. 19

No SIM 5:59 PM 38%

< Back COMPASS CONNECT

### SELECT FLOOR PLAN

Scroll to select the floor plan of your RV.

- ☐ 2250RK
- ☐ 2400BH
- ☒ 2450RL
- ☐ 2500RL
- ☐ 2600RB

Continue >>

Fig. 20

No SIM 5:59 PM 37%

COMPASS CONNECT

### CONFIRM RV DETAILS

Confirm that the RV details are correct.

- Year 2018 >
- Make Grand Design Rv Llc
- Model Imagine >
- Floor Plan 2450RL >

Confirm >>



10. Press Let's Go! to set up a PIN (Fig. 21A). Setting a PIN (Fig.22) will require it to be entered each time the application is opened. Optionally, press Skip (Fig. 22A) to bypass the PIN setup.
11. Compass setup is complete (Fig. 23). Press Continue to App (Fig. 23A).

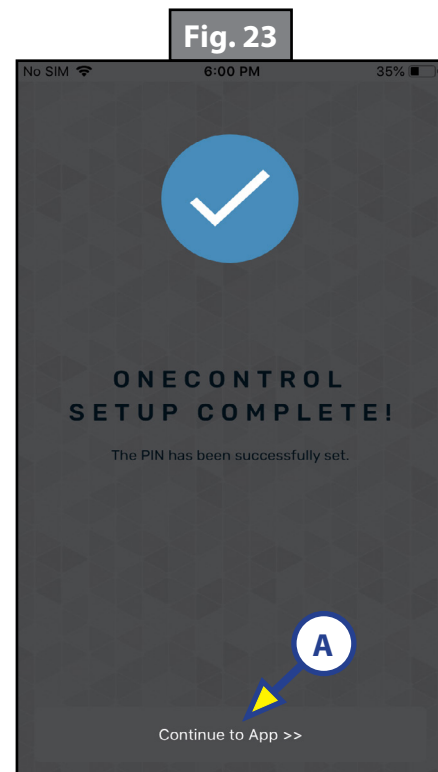
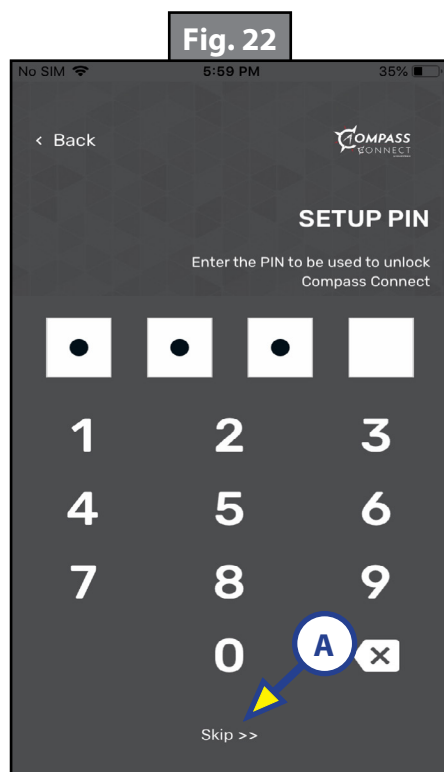
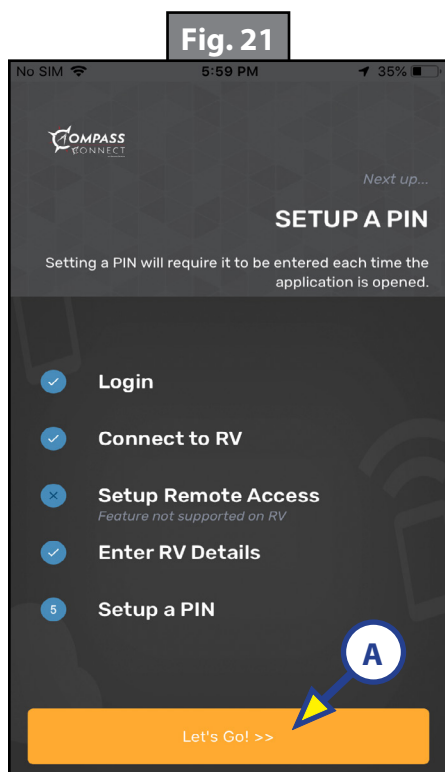

## Operation

### HOME Screen

1. All lighting can be turned on or off by clicking on the Turn Off/Turn On All Lights buttons (Figs. 24A and 25A) on the HOME Screen.
2. The Favorite Device shortcut option, and other settings for the device, can be accessed by clicking on the device's next button (>) (Fig. 25B) to open its settings screen.

**NOTE:** Selecting Yes for a Favorite Device (Fig. 26A) places a shortcut for the device's settings in the HOME screen. Selecting No (Fig. 27A) deletes the device shortcut from the HOME screen (Fig. 28).

- B. If the listed favorite devices have a quick settings slider button preceding the device name (Fig. 24B), the device can be turned on or off by this button without having to open the device's full set of options.
- C. However, doing so bypasses other device options.
3. After making setting changes, click on the device's back button (<) (Fig. 26B) to return to the HOME screen.

Fig. 24



Fig. 25

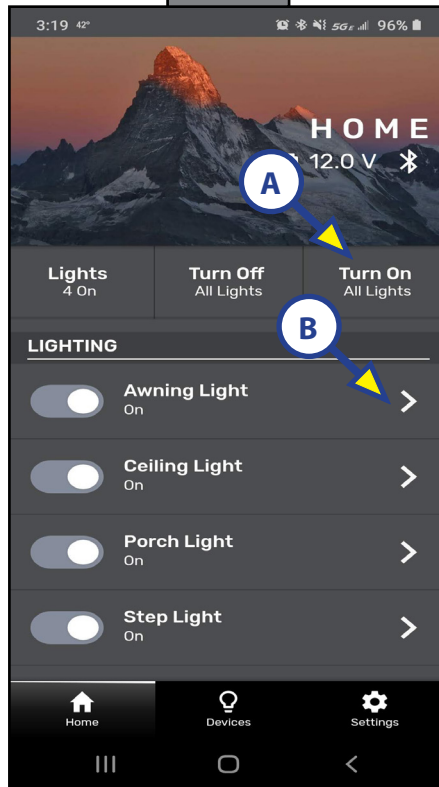

Fig. 26

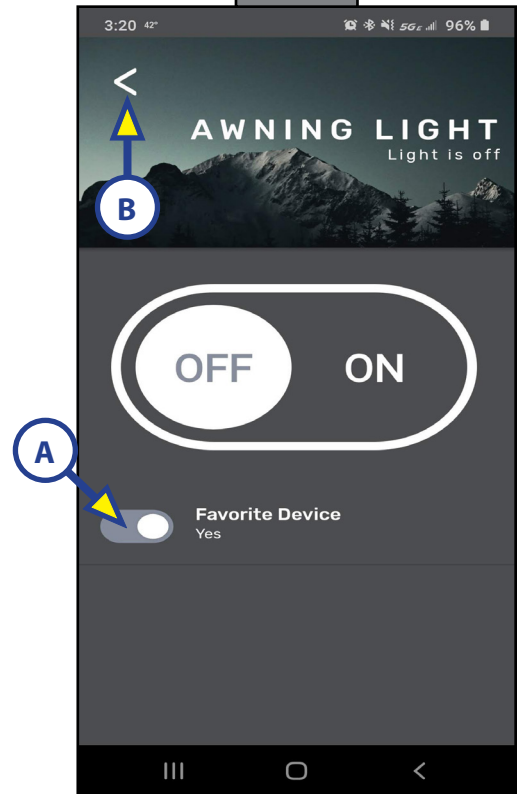

Fig. 27

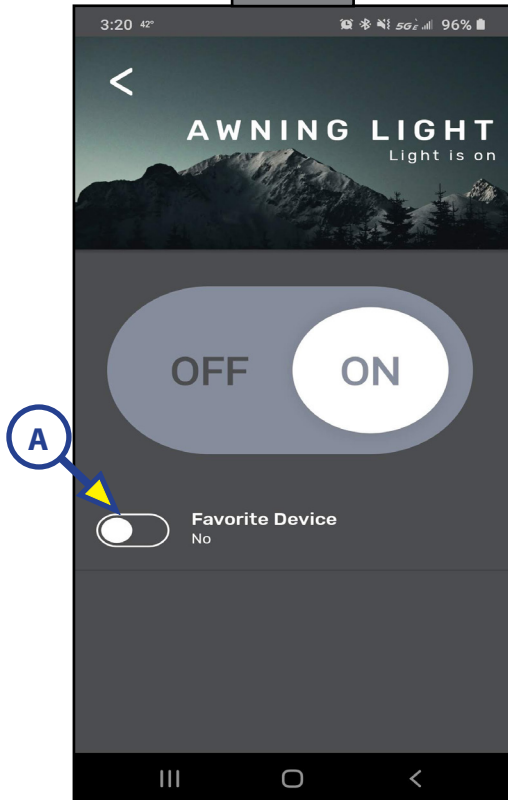
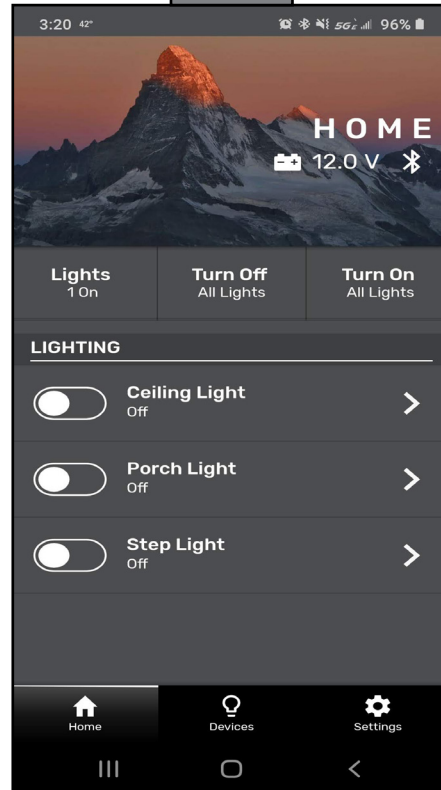

Fig. 28





## DEVICES Screen

1. The DEVICES category icon is in the center of the three icons on the bottom of the screen (Fig. 29A).
2. The DEVICES category screen offers two navigational options: Groups and All (Fig. 29).
  - A. The Groups navigational option alphabetically lists the trailer's available features: Awnings, Lighting, Slides and Stabilizers.
  - B. Groups shows the number of features for that category by the number of light blue horizontal bars directly above the group name (Fig. 29). For instance, Lighting has 3 bars for 3 features, etc.
  - C. The All navigational option alphabetically lists all available features, regardless of grouping, whether the device is turned off or on or is set as a Favorite Device.
  - D. From the Groups menu, selecting a feature group opens the individual features for that group.
    - I. For example, selecting AWNING opens the AWNING category.
    - II. The number of devices in that category is stated under the category name in the left navigation bar.
    - III. Each device has a next button (>) (Fig. 30A) that indicates settings are available for that device. Pressing anywhere on the device name or next button (>) will open the device's settings window (Fig. 31).
3. To use a feature, press the name of a feature group and select the device to be operated.
  - A. Press the AWNING feature (Fig. 29) and select Awning1 or Awning2 (Fig. 30). Press (–) to retract the awning and press (+) to extend the awning (Fig. 31). The screens in Figs. 32 and 33 display the awning's current action.
  - B. Press the LIGHTING feature (Fig. 24) and select Awning Light, Ceiling Light, Porch Light or Step Light (Fig. 34). Turn OFF or ON.
  - C. Press the SLIDE feature (Fig. 24) and select Slide1, Slide2, Slide3 or Slide4. Press (–) to retract the slide and press (+) to extend the slide (Fig. 36).

Fig. 29

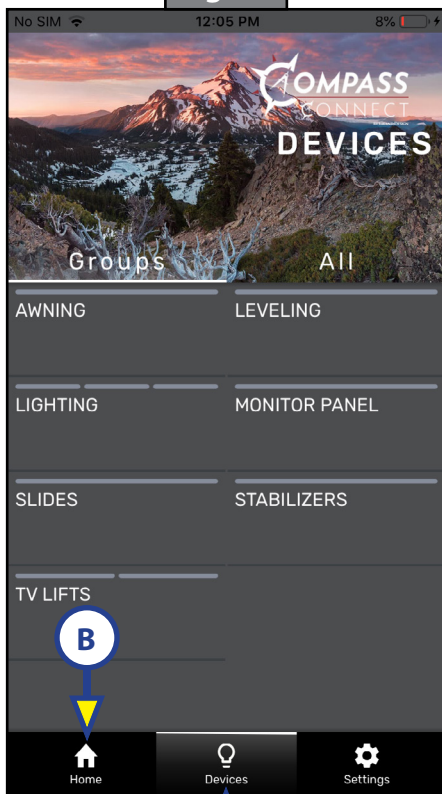

A

Fig. 30

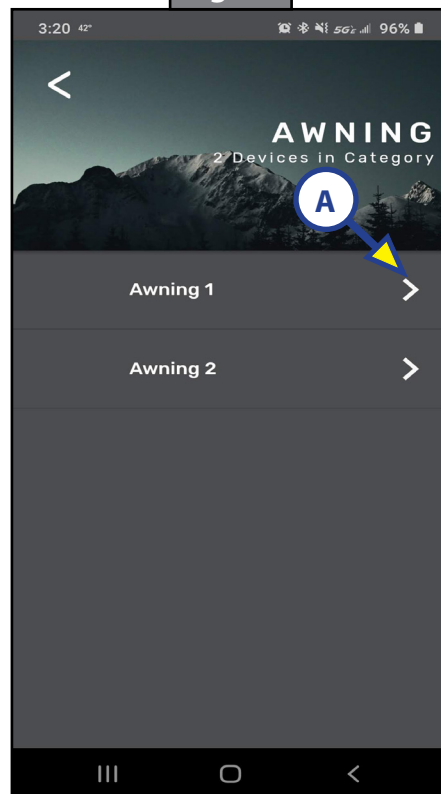
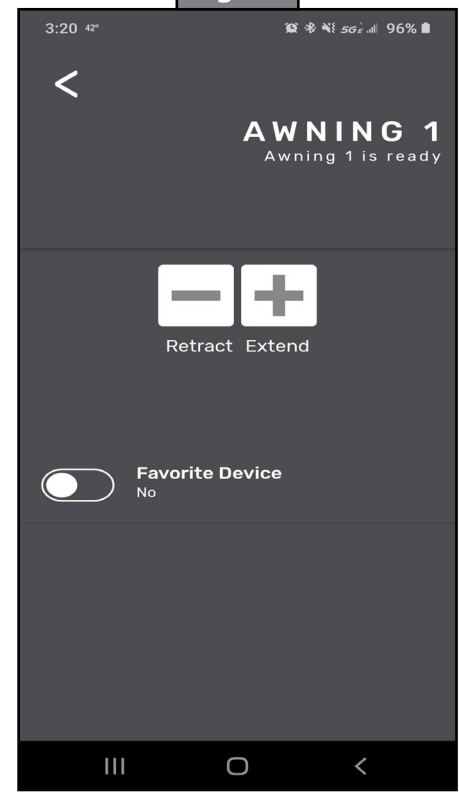
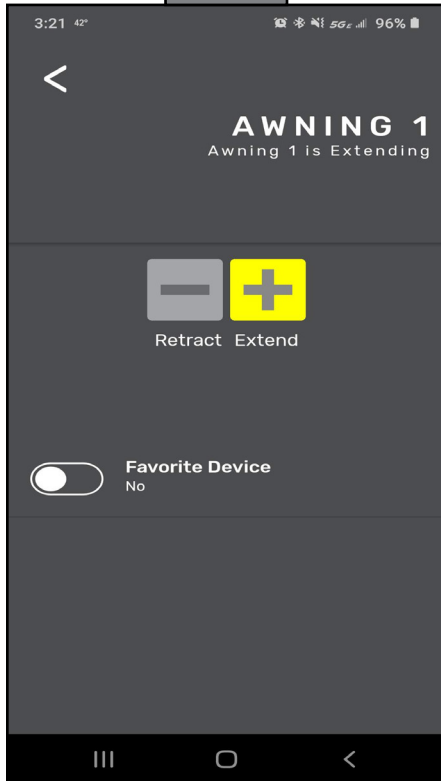

Fig. 31



- D.** Press the STABILIZER feature (Fig. 29) and select Front Stabilizer or Rear Stabilizer (Fig. 37). Press UP or DOWN.
- After all desired options for devices within the selected group have been set, click on the category back button (<) left of the category name to return to the Devices category screen (Fig. 29).
  - When done setting options from the DEVICES screen (Fig. 29), click on the Home icon (Fig. 29B) to return to the main HOME screen.

**Fig. 32**



**Fig. 33**

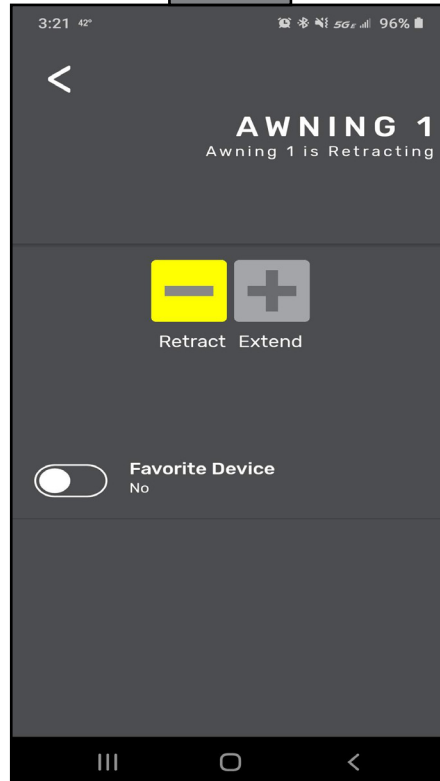

**Fig. 34**

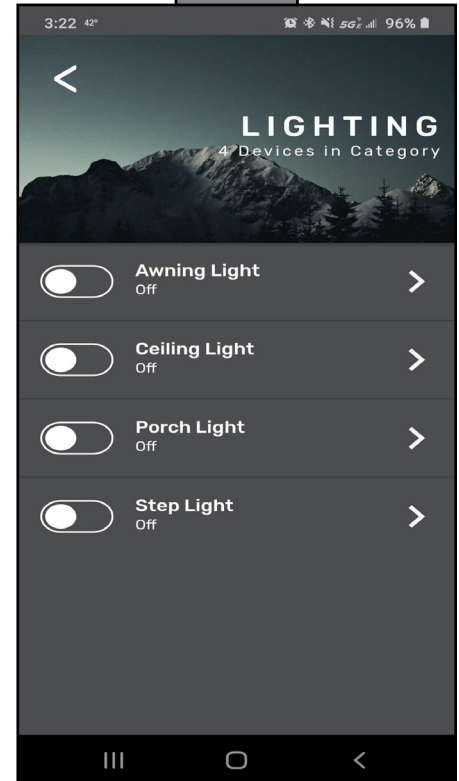

**Fig. 35**

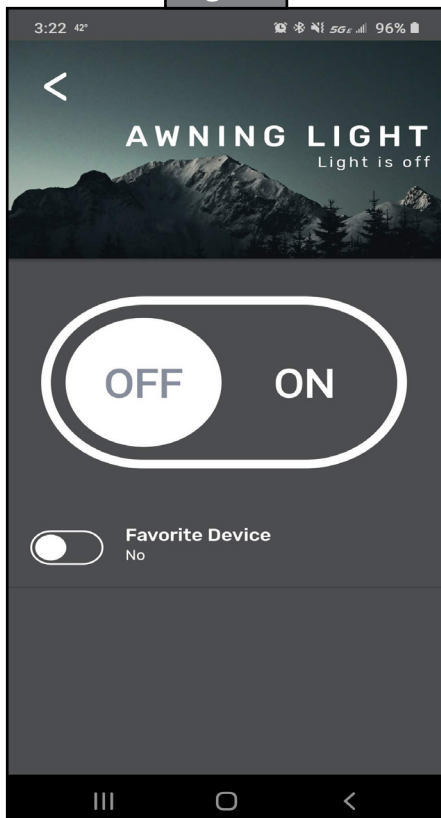

**Fig. 36**



**Fig. 37**

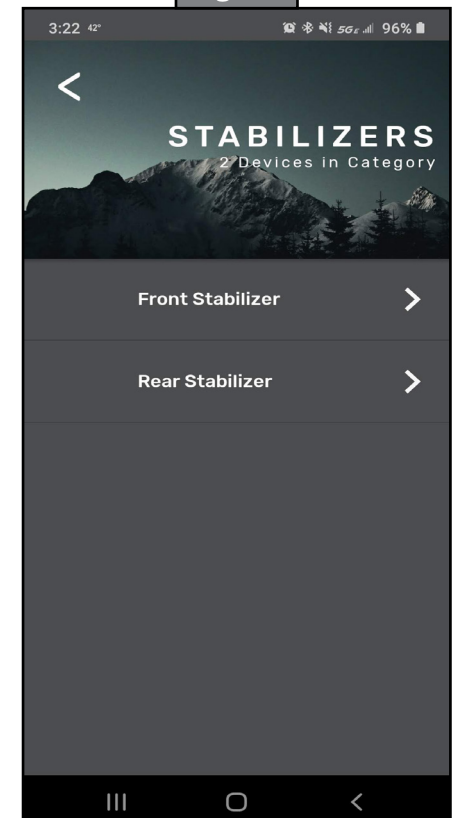

SETTINGS Screen

- 1. The SETTINGS category tab is located on the bottom right of the screen (Fig. 38A ).
- 2. The SETTINGS category offers options (Fig. 38): Diagnostics, Resync Devices, Units, Connection, Login/Create Account, PIN and Add an accessory.
  - A. Below each setting option name is a brief description of the option.
  - B. Clicking on a setting's option's next button (>) (Fig. 38B) opens that option's settings window (Fig. 34).
  - C. Click on the option's main back button (<) (Fig. 39A) to return to the Settings main screen.
- 3. Brief descriptions of Settings (Fig. 38) options:

**NOTE:** This is a device summary report only. Device settings cannot be made through this option. Device settings can only be changed through the Devices screen.

- A. Diagnostics — App Version: System Report, snapshot summary of trailer’s available devices.
- B. Resync — Removes “off-line” devices. This option is used to resync the system devices after one has been removed, serviced or repaired and shown to be off-line.
- C. Units — Shows the currently selected temperature unit of scale (Fig. 40).
- D. Connection — Shows Bluetooth connection.
- E. Login/Create — Offers the Log In and Create Account options.
- F. PIN — Allows the PIN to be changed.
- G. Add an accessory — Allows users to add accessory products to their RV.

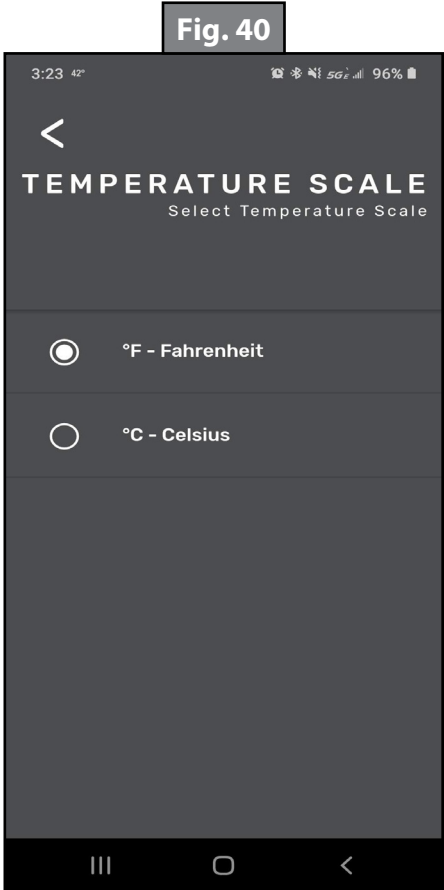
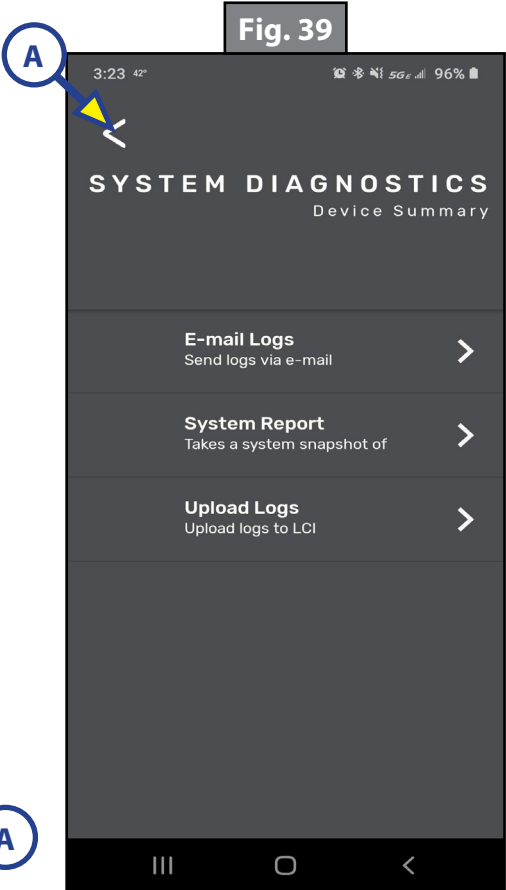
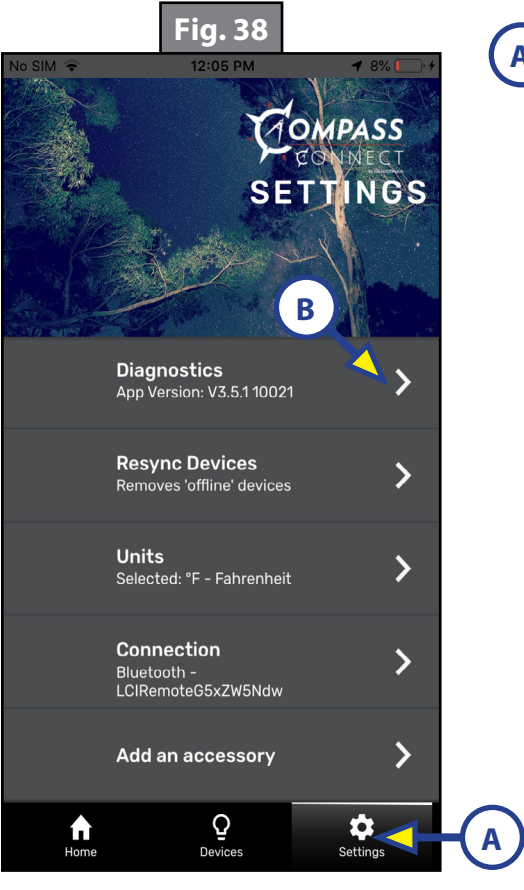

Troubleshooting

What is Happening	Why?	What Should Be Done?
Device not available.	Device not configured.	Contact Lippert Components, Inc.
Manual switches are locked out.	User has function open.	Disengage lockout feature by pressing any manual switch.



# L I P P E R T C O M P O N E N T S®

The contents of this manual are proprietary and copyright protected by Lippert Components, Inc. (LCI). LCI prohibits the copying or dissemination of portions of this manual unless prior written consent from an authorized LCI representative has been provided. Any unauthorized use shall void any applicable warranty. The information contained in this manual is subject to change without notice and at the sole discretion of LCI.

Revised editions are available for free download from [lci1.com](http://lci1.com).

Please recycle all obsolete materials.

For all concerns or questions, please contact  
Lippert Components, Inc.

Ph: (574) 537-8900 | Web: [lci1.com](http://lci1.com) | Email: [customerservice@lci1.com](mailto:customerservice@lci1.com)